

FED. ROAD DIV. No.	STATE	F.A. PROJECT NO.	FISCAL YEAR	SHEET No.
3	FLA.	RS - 4854 - (5)		12

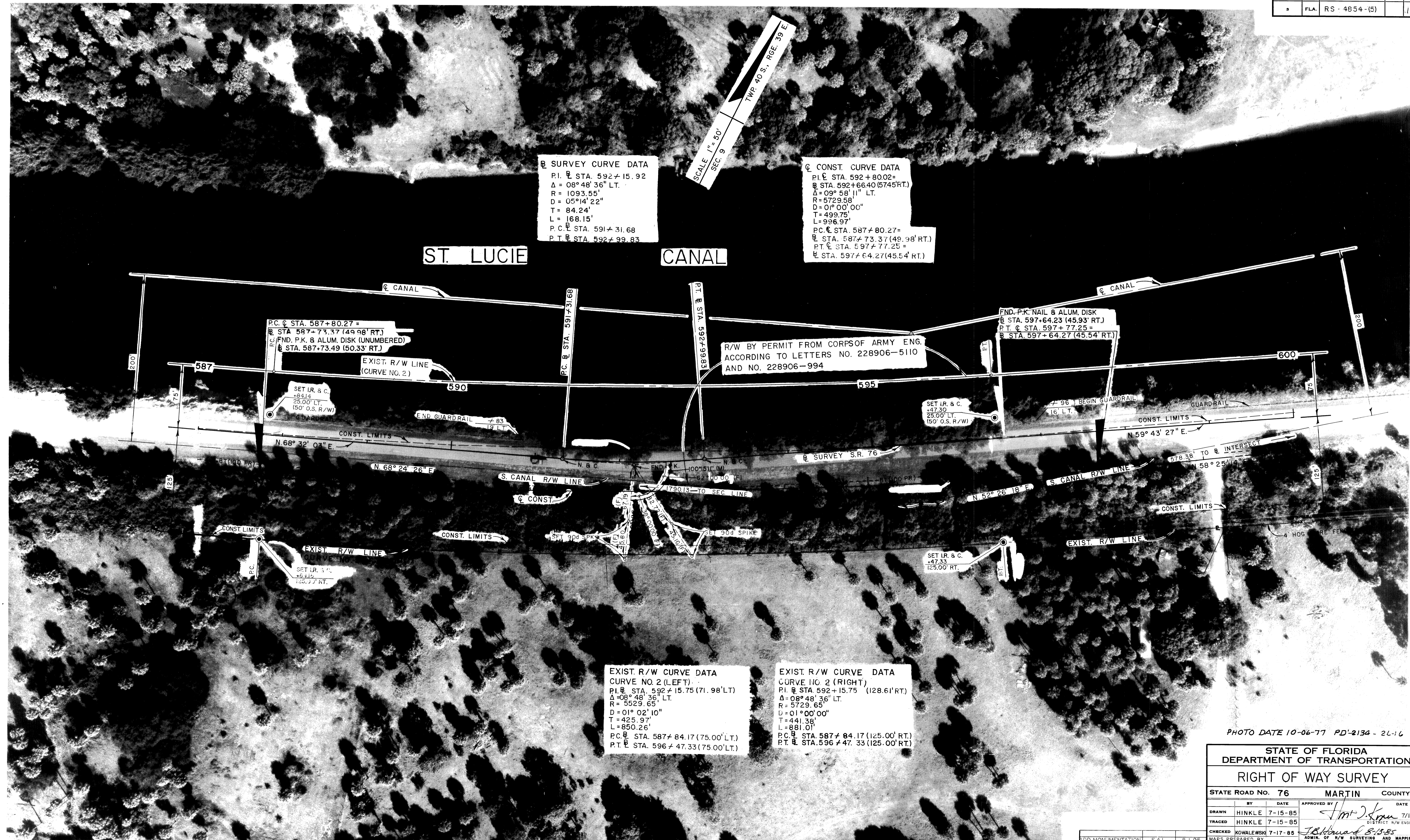

☉ SURVEY CURVE DATA
 P.I. ☉ STA. 592+15.92
 $\Delta = 08^{\circ} 48' 36''$ LT.
 R = 1093.55'
 D = 05°14'22"
 T = 84.24'
 L = 168.15'
 P.C. ☉ STA. 591+31.68
 P.T. ☉ STA. 592+99.83

☉ CONST. CURVE DATA
 P.I. ☉ STA. 592+80.02=
 ☉ STA. 592+66.40 (57.45' RT.)
 $\Delta = 09^{\circ} 58' 11''$ LT.
 R = 5729.58'
 D = 0°00'00"
 T = 499.75'
 L = 996.97'
 P.C. ☉ STA. 587+80.27=
 ☉ STA. 587+73.37 (49.98' RT.)
 P.T. ☉ STA. 597+77.25=
 ☉ STA. 597+64.27 (45.54' RT.)

P.C. ☉ STA. 587+80.27 =
 ☉ STA. 587+73.37 (49.98' RT.)
 FND. P.K. & ALUM. DISK (UNNUMBERED)
 ☉ STA. 587+73.49 (50.33' RT.)

R/W BY PERMIT FROM CORP OF ARMY ENG.
 ACCORDING TO LETTERS NO. 228906-5110
 AND NO. 228906-994

FND. P.K. NAIL & ALUM. DISK
 ☉ STA. 597+64.23 (45.93' RT.)
 P.T. ☉ STA. 597+77.25 =
 ☉ STA. 597+64.27 (45.54' RT.)

EXIST. R/W CURVE DATA
 CURVE NO. 2 (LEFT)
 P.I. ☉ STA. 592+15.75 (71.98' LT.)
 $\Delta = 08^{\circ} 48' 36''$ LT.
 R = 5529.65'
 D = 01°02'10"
 T = 425.97'
 L = 850.26'
 P.C. ☉ STA. 587+84.17 (75.00' LT.)
 P.T. ☉ STA. 596+47.33 (75.00' LT.)

EXIST. R/W CURVE DATA
 CURVE NO. 2 (RIGHT)
 P.I. ☉ STA. 592+15.75 (128.61' RT.)
 $\Delta = 08^{\circ} 48' 36''$ LT.
 R = 5729.65'
 D = 01°00'00"
 T = 441.38'
 L = 881.01'
 P.C. ☉ STA. 587+84.17 (125.00' RT.)
 P.T. ☉ STA. 596+47.33 (125.00' RT.)

NOTE: ALL DISTANCES AND ANGLES FOLLOWED BY (M) ARE BASED ON FIELD MEASUREMENTS MADE DURING THE R/W MONUMENTATION SURVEY.

(SEE SHEET 1 FOR NOTES, SURVEYOR'S NOTES, & SURVEYOR'S CERTIFICATE)

☉ DENOTES R/W MARKER (SET I.R. & C.)

PHOTO DATE 10-06-77 PD-2134 - 2L-16

STATE OF FLORIDA DEPARTMENT OF TRANSPORTATION			
RIGHT OF WAY SURVEY			
STATE ROAD NO. 76		MARTIN COUNTY	
BY	DATE	APPROVED BY	DATE
DRAWN HINKLE	7-15-85	<i>J. H. Kowalewski</i>	7/17/85
TRACED HINKLE	7-15-85		
CHECKED KOWALEWSKI	7-17-85		
MAPS PREPARED BY	DISTRICT 4	ADMIN. OF R/W SURVEYING AND MAPPING	
VOID R/W 2	KYRTHOFF 7/21/88	FIELD BOOK NO'S 1009746	
3rd R/W R.A. 2	BRIDGES - T.L.B. 11-17-86	W.P.I. NO. 4116124	
		1017764, 1010298, 1018530, 1017763	
SECTION 89060-2508		SHEET 12 OF 17	

ADD MONUMENTATION	E.A.L.	DATE
VOID R/W 2	KYRTHOFF	7/21/88
3rd R/W R.A. 2	BRIDGES - T.L.B.	11-17-86
REVISION	BY	DATE